

OMNIFIT

USER MANUAL
[OCB-R10]



INCLUDED IN THE PACKAGE



OCB-R10 RING



CHARGING CRADLE



USB CHARGING CABLE



USER MANUAL

Actual product design may differ from images shown in manual.

DESCRIPTION OF PARTS

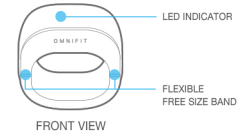

FRONT VIEW

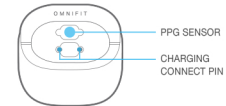

INNER VIEW

CRADLE COVER

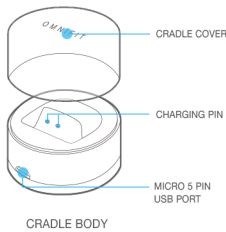

CRADLE BODY

HOW TO CHARGE



- 01 Place the ring on the cradle with the OMNIFIT logo of ring facing up. Two pogo pins on the cradle have to contact the charging connect pin of Ring.

Note:
If it place correctly, the LED indicator will show a solid red light while charging.

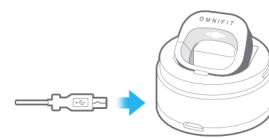

- 02 Connect 5 pin micro-USB cable onto the cradle.

CHARGING STATUS ALERT

- Solid Red Light On (While Charging)
- Solid Green Light On (Charging Completed)



- Battery status can be checked by OMNIFIT App.
- Be sure to charge the battery sufficiently to prevent the power from turning off during data transmitting to OMNIFIT App.

HOW TO WEAR

- 01 Wear on the index finger or others with the LED indication light facing up.
- 02 Make sure that the ring's PPG sensor is in close contact with your finger.



- Do not pull the side rubber band intentionally.
- If the measuring is unstable, turn it 180 degrees, facing down the logo of ring, and wear it.

CONNECTING THE RING

[BEFORE PAIRING]

- 01 Requires Android 4.3 or iOS 9.0 higher operation system on your phone, and supports Bluetooth 4.0 (BLE)
- 02 On your phone, download the OMNIFIT RING app from the Play Store or Apple store and install it.



- 03 Place your mobile phone next to your ring.
- 04 Make sure your phone is connected to mobile data or Wi-Fi. You will need a data connection to set up your ring for the first time.
- 05 Keep the ring with sufficient battery status.

CONNECTING THE RING

[HOW TO PAIR YOUR RING]

To use the ring, connect with your mobile device.



- 01 Turn on Bluetooth of your phone during setup, if it isn't already on.
- 02 Open the OMNIFIT app on your phone.
- 03 Tab top-left menu button.
- 04 Tab 'Device' on your phone and tab 'Search'. You will see a list of Ring and select one.
- 05 Follow the onscreen instruction to complete the initial setup.
- 06 Enjoy the OMNIFIT Ring.

LED INDICATOR

FUNCTION	INDICATOR	
	Solid(On)	Solid(Blink)
Charging	●	
Charging complete	●	
Low Battery		●
Bluetooth connected	●	
Bluetooth disconnected		●

SPECIFICATION

Ring	Battery	Lithium Polymer Battery, 3.7V
	Charging	Micro PIN
	Sensor	PPG/Motion Sensor
	Connect	Bluetooth V4.1 / NFC
	Size	272mm*158mm*251mm
Cradle	Weight	13 g
	Material	PC(polycarbonate), Zn metal, Silicon
	Input	5.0 V, 500 mA
	Operation Surroundings	5℃ ~ 40℃ / 30% ~ 80%
	Output	Micro USB port
Cradle	Input	5.0 V 500 mA (USB port)

PRECAUTIONS

- Keep the device away from excessive humidity and dust.
- Do not expose over 50 degree temp and under 5 degree temp.
- Do not modify, repair, or disassemble.
- Do not drop the device.
- Do not expose directly to flammables.
- Only charge the ring with certified charger, otherwise it may be damaged.
- Keep out of reach of children.
- Use dried cloth to clean the ring.
- Do not use when you are allergic to the metal.
- Do not expose directly to water even if the device support IPx4.
- Do not use this device as for medical treatment or diagnosis.

LIMITED WARRANTY

Subject to the conditions of this Limited Warranty, OMNI C&S warrants this product to be free from defects in design, material and workmanship at the time of its original purchase by a consumer, and for a subsequent period of one (1) year. Should your product need warranty service, please return it to the dealer from whom it was purchased or contact www.omnifit.co.kr/contact (+82-2-868-5452) to get further information.

Conditions

- The warranty is valid only if the original receipt issued to the original purchaser by the dealer, specifying the date of purchase and serial number, is presented with the product to be repaired or replaced. OMNI C&S reserves the right to refuse warranty service if this information has been removed or changed after the original purchase of the product from the dealer.
- This Warranty does not cover any failure of the product due to normal wear and tear, or due to misuse, including but not limited to use in other than the normal and customary manner, in accordance with instructions for use and maintenance of the product. Nor does this warranty cover any failure of the product due to accident, modification or adjustment, acts of God or damage resulting from liquid.
- There are no express warranties, whether written or oral, other than this printed including without limitation the implied warranties of merchantability or fitness for a particular purpose, are limited to the duration of this limited warranty. In no event shall OMNI C&S or its vendors be liable for incidental or consequential damages of any nature whatsoever, including but not limited to loss of profits or commercial loss, to the full extent those damages can be disclaimed by law.

OMNIFIT RING

www.omnifit.co.kr
Contact +82-2-868-5452